

SAFETY LABELS

1. LOCATION

Always keep these labels clean. If they are lost or damaged, attach them again or replace them with a new label.

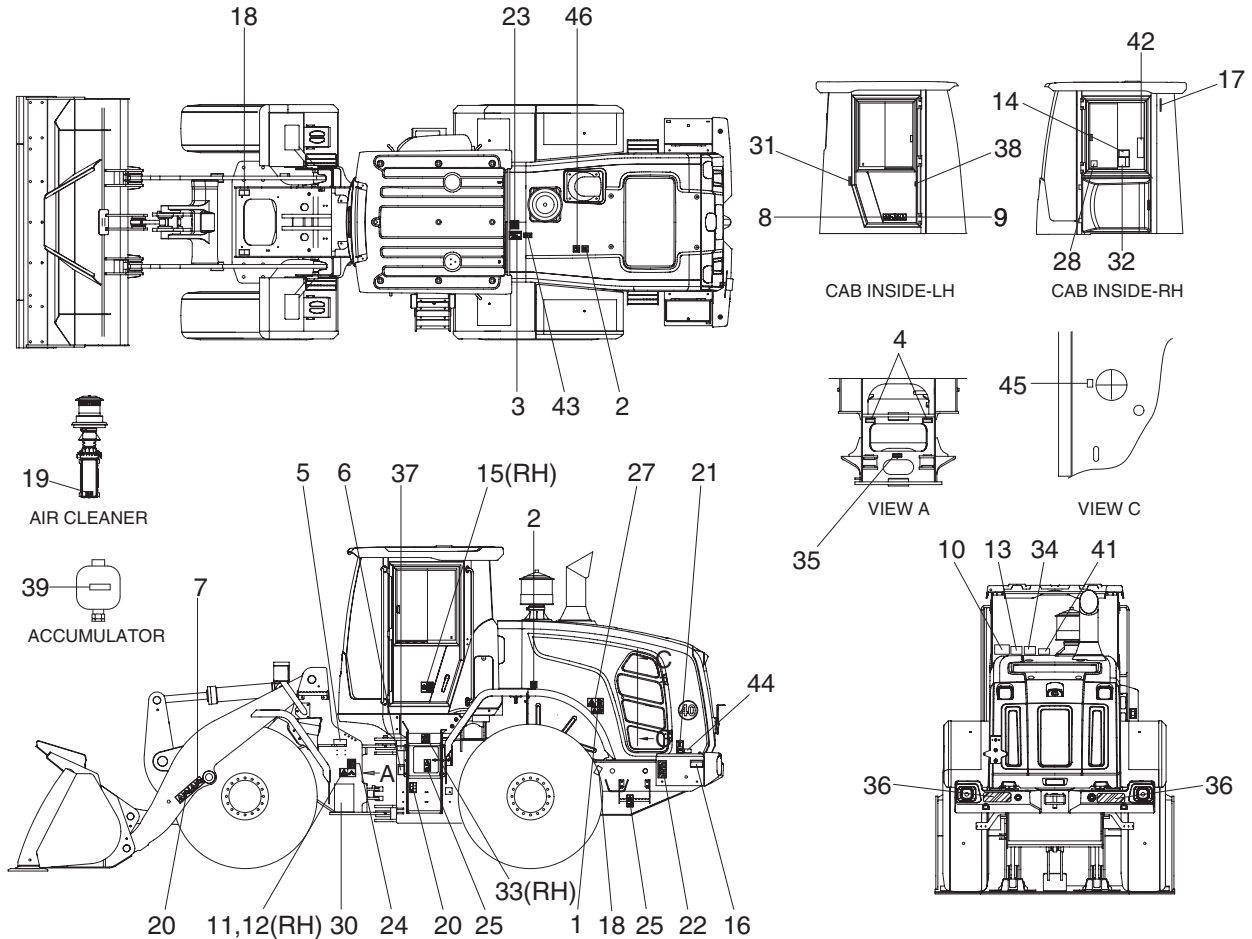

9350FW03

- | | | |
|---------------------------|---------------------------|--|
| 1 Start motor | 16 Electric welding | 33 Diesel exhaust fluid |
| 2 Turbocharger cover | 17 Hammer | 34 Specification sheet |
| 3 Hyd oil level | 18 Lift & tie | 35 Grease (center) |
| 4 Ride control (option) | 19 Air cleaner | 36 Keep clear/Reflect |
| 5 Grease (A) | 20 Quick coupler (option) | 37 Name plate |
| 6 Grease (B) | 21 Fueling | 38 ROPS plate |
| 7 Bucket stopper | 22 Battery accident | 39 Accumulator |
| 8 Max h/reach | 23 Hyd oil lub | 41 Caution (water separator, turbocharger) |
| 9 Roll over | 24 High pressure hose | 42 Tilt handle |
| 10 ROPS cab | 25 Falling | 43 Fuel shut off |
| 11 Steering warning-LH | 27 Engine door shearing | 44 Ultra low sulfur diesel |
| 12 Steering warning-RH | 28 Alternate exit | 45 Emergency fire hole |
| 13 Engine start caution | 30 Service instruction | 46 No step |
| 14 Control ideogram | 31 Fire extinguisher | |
| 15 Air conditioner filter | 32 Start procedure | |

2. DESCRIPTION

There are several specific warning labels on this machine please become familiarized with all warning labels.

Replace any safety label that is damaged, or missing. If a safety label is attached to a part that is replaced, install a safety label on the replacement part.

1) START MOTOR (item 1)

This warning label is positioned on the left side of the engine side cover.

- ▲ **Start the engine only from the operator's compartment. Never short across the starter terminals or across the batteries. Shorting could bypass the engine neutral start system. Shorting could also damage the electrical system.**



77070FW05

2) TURBOCHARGER COVER (item 2)

This warning label is positioned on the turbocharger cover.

- ▲ **Do not touch turbocharger or it may cause severe burn. When the engine is running or immediately after engine shut down.**



21070FW02

3) HYDRAULIC OIL LEVEL (item 3)

This warning label is positioned on the top of hydraulic oil tank.

- ▲ **Place the bucket on the ground whenever servicing the hydraulic system.**
- ※ **Check oil level on the level gauge.**
- ※ **Refill the recommended hydraulic oil up to specified level if necessary.**



7609A0FW06

4) RIDE CONTROL (item 4)

This warning label is positioned on the front frame.

Before checking the boom operation system,

1. Bucket should be laid on the ground.
2. Turn out the drain screw in ride control valve to release the charged oil in accumulators.

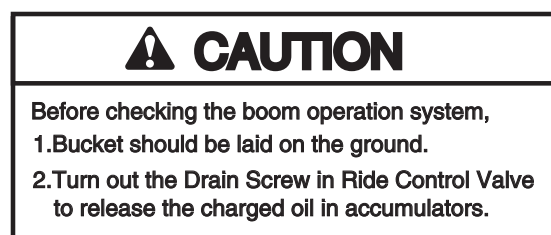

7707A0FW06

5) BUCKET STOPPER (item 7)

This warning label is positioned on the middle of the boom.

- ⚠ When working under or around the bucket or linkage, with bucket raised, proper support must be provided for the bucket and/or the linkage.

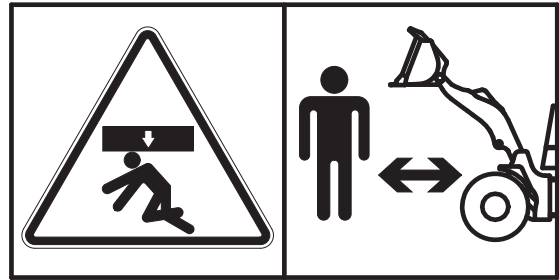

7803AFW05

6) MAX HEIGHT (item 8)

This warning label is positioned on the left side window of the cab.

- ⚠ Serious injury or death can result from contact with electric lines. An electric shock being received by merely coming into the vicinity of an electric lines, the minimum distance should be kept considering the supply voltage as page 1-6.

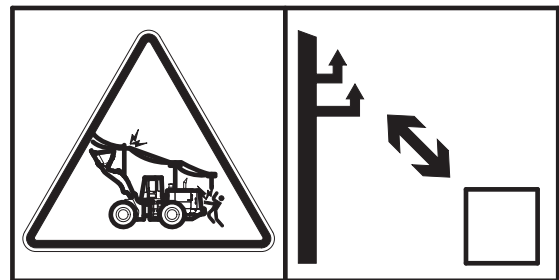

7803AFW16

7) ROLL OVER (item 9)

This warning label is positioned on the left side window of the cab.

- ⚠ Structural damage, an overturn, modification, alternation, or improper repair can impair this structure's protection capability thereby voiding this certification.
- ⚠ Always use seat belt when operating your machine. Always check the condition of the seat belt and the condition of the mounting hardware before you operate the machine.



77070FW14

8) STEERING WARNING (item 11, 12)

The warning label is positioned on the both side of the front frame.

- ⚠ No clearance for person in this area when machine turns.
- ⚠ Severe injury or death from crushing could occur.



77070FW07

9) ENGINE START CAUTION (item 13)

This warning label is positioned on the right side window of the cab.

- ▲ **Study the operator's manual before starting and operating machine.**

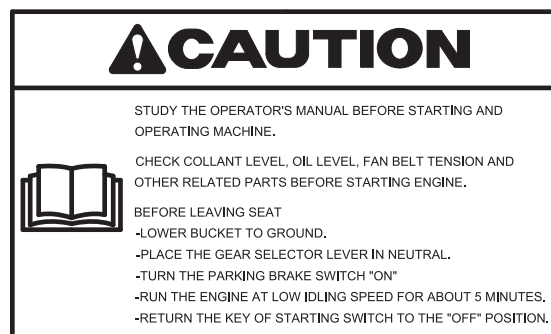

10) CONTROL IDEOGRAM (item 14)

This warning label is positioned on the right side window of the cab.

- ▲ **Confirm the operation of control lever and working device before operating the machine.**

※ Refer to the page 4-9 for details.

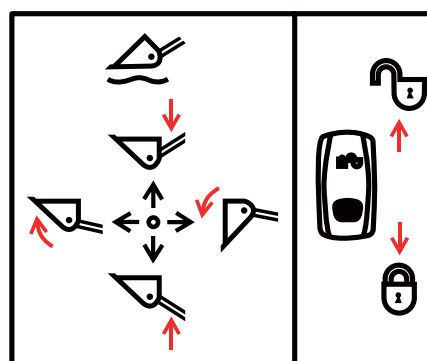

11) AIR CONDITIONER FILTER (item 15)

This warning label is positioned on the air-conditioner filter.

- ※ **Periodic and proper inspection, cleaning and change of filter prolong air conditioner life time and maintain good performance.**

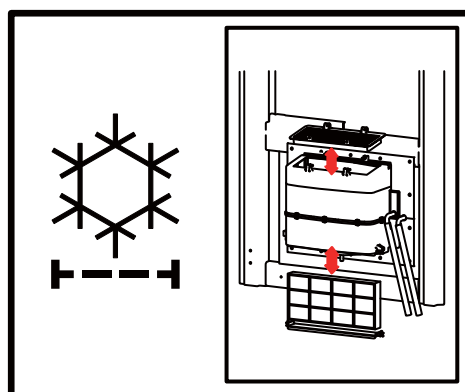

12) ELECTRIC WELDING (item 16)

This warning label is positioned on the side of the battery box.

- ▲ **Before carrying out any electric welding on this machine**

- Pull the connectors out of all electronic control units.
- Connect the ground lead of the welding equipment as close to the welding point as possible.

※ Refer to the page 6-48 for details.

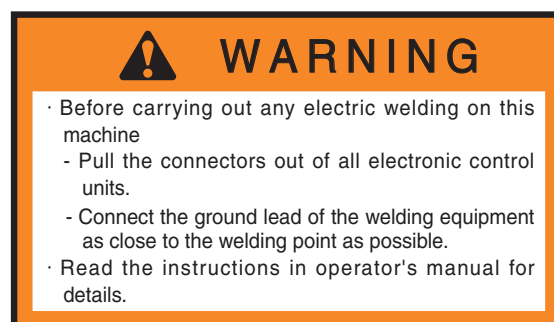

13) LIFT & TIE (item 18)

This label is positioned on the both side of the front and rear frame.

- Lifting point

In order to lift the machine, attach the lifting devices to the lifting points.

- Tying point

In order to tie down the machine, attach the tie-downs to the tying points.

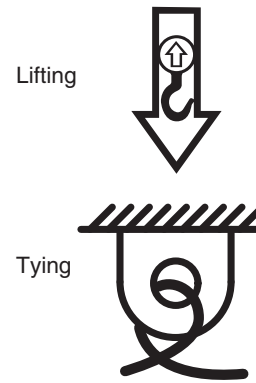

75790FW04

14) AIR CLEANER (item 19)

The warning label is positioned on the air cleaner.

- ⚠ Periodic and proper inspection, cleaning and change of elements prolong engine life time and maintain the good performance of engine.

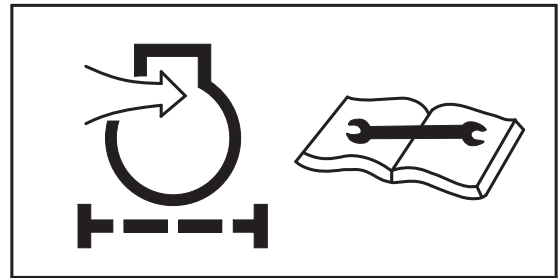

21070FW01

15) QUICK COUPLER (item 20)

This warning label is positioned on the middle of the boom.

- ※ Serious injury or death can result from dropping bucket.
- ※ Operating the machine with attachment switch unlocked or without safety pin of moving hook can cause the bucket to drop off.



757TM9A0FW30

16) FUELING (item 21)

This warning label is positioned on the left side of fuel filler neck.

- ⚠ **Stop the engine when refueling. All lights or flames shall be kept at a safe distance while refueling.**

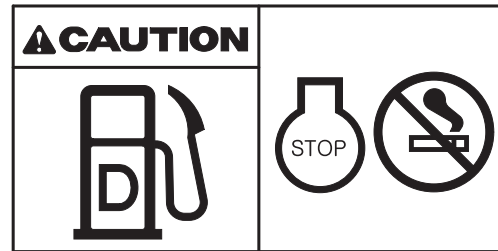

21070FW04

17) BATTERY ACCIDENT (item 22)

This warning label is positioned on the battery box.

- ⚠ **Electrolyte containing sulfuric acid cause severe burns. Avoid being in contact with skin, eyes or clothes. In the event of accident flush with sufficient water, call a physician immediately.**
- ※ **Maintain the electrolyte at the recommended level. Add distilled water to the battery only when starting up, never when shutting down.**
With electrolyte at proper level, less space may cause the gases to be accumulated in the battery.
- ⚠ **Extinguish all smoking materials and open flames before checking the battery.**
- ⚠ **Do not use matches, lighters or torches as a light source near the battery for the probable presence of explosive gas.**
- ⚠ **Do not allow unauthorized personnel to change the battery or to use booster cables.**
- ⚠ **For safety from electric shock, do not battery terminal with a wet hand.**

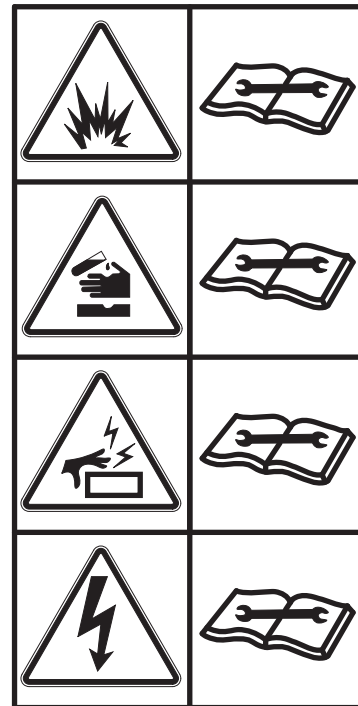

7579A0FW30

18) HYDRAULIC OIL LUB (item 23)

This warning label is positioned on the top of the hydraulic oil tank.

- ※ **Do not mix with different brand oils.**
- ⚠ **Never open the filler cap while engine running or at high coolant temperature.**
- ⚠ **Loosen the cap slowly and release internal pressure completely.**



14070FW08

19) HIGH PRESSURE HOSE (item 24)

This warning label is positioned on the left side of the front frame.

- ⚠ Escaping fluid under pressure can penetrate the skin causing serious injury.
- ⚠ Avoid the hazard by relieving pressure before disconnecting hydraulic lines or other lines.
- ※ See the maintenance section for details.



14070FW29

20) ENGINE DOOR SHEARING (item 27)

This warning label is positioned on the left side of the engine side door.

- ⚠ Don't open the engine door during the engine's running. Stay clear of rotating parts.
- ⚠ Don't touch exhaust pipe or it may cause severe burn.

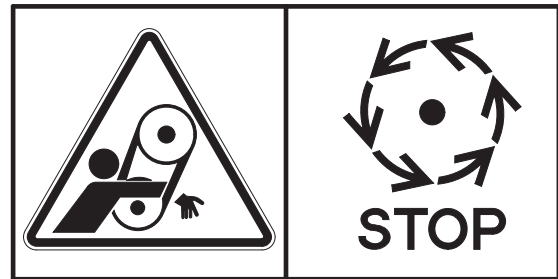

21070FW15

21) ALTERNATE EXIT (item 28)

This warning label is positioned on the right side window of the cab.

- ※ The right window serve as an alternate exit.
- ※ Refer to the page 3-59.

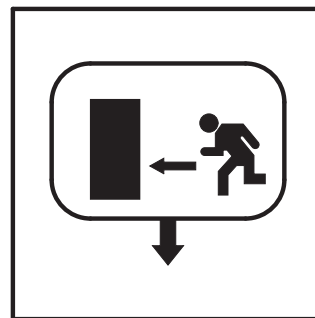

77070FW12

22) START PROCEDURE (item 32)

This warning label is positioned on the right side window of the cab.

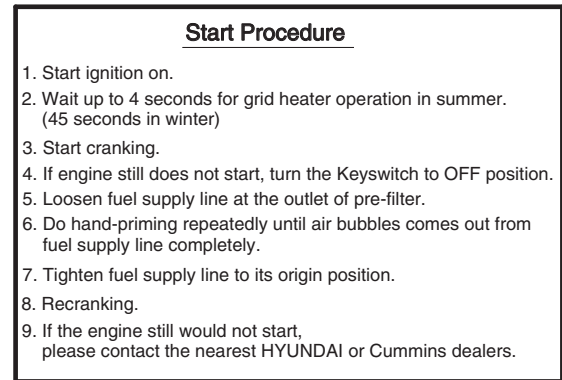

7609A0FW07

23) DIESEL EXHAUST FLUID (item 33)

This warning label is positioned on the right side of the rear frame.

- ※ Fill only the DEF/AdBlue® (Diesel Exhaust Fluid, standardised as ISO 22241).

Aqueous urea solution made with 32.5% high-purity urea and 67.5% deionized water.

- ※ Do not fill the diesel fuel.



760F0FW13

24) ACCUMULATOR (item 39)

This warning label is positioned on the accumulator of the solenoid valve.

- ※ The accumulator is filled with high-pressure nitrogen gas, and it is extremely dangerous if it is handled in the wrong way. Always observe the following precautions.

- ⚠ Never make any hole in the accumulator expose it to flame or fire.
- ⚠ Do not weld anything to the accumulator. When carrying out disassembly or maintenance of the accumulator, or when disposing of the accumulator, it is necessary to release the gas from the accumulator. A special air bleed valve is necessary for this operation, so please contact your Hyundai distributor.



1107A0FW46

25) CAUTION (WATER SEPARATOR, TURBOCHARGER) (item 41)

This warning label is positioned on the right side window of the cab.

- ⚠ In order to protect high pressure fuel system, please drain water in water separator before starting the engine.
- ⚠ In order to prevent turbocharger failure, please allow more than 5 minutes' cool down period (no load low idle operation) before shutting the engine off.

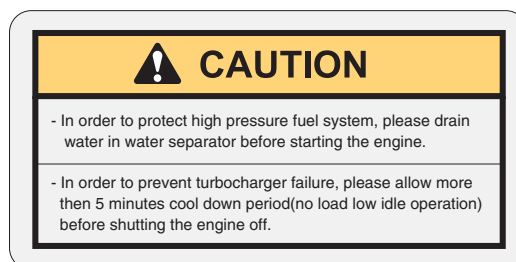

120090SL02

26) TILT HANDLE (item 42)

This warning label is positioned on the right side window of the cab.

- ※ The right side window can be used as an alternate exit.
- ※ Refer to the page 3-59.

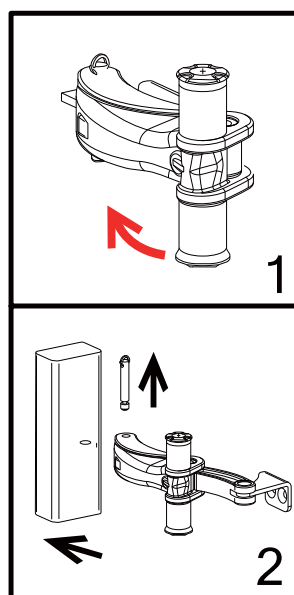

760F0FW14

27) FUEL SHUT OFF (item 43)

This warning label is positioned on the hydraulic tank.

- ※ Fill only the hydraulic oil.
- ※ Do not fill the diesel fuel.
- ⚠ Relieve tank pressure with the engine off by removing the cap slowly to prevent burns from hot oil.

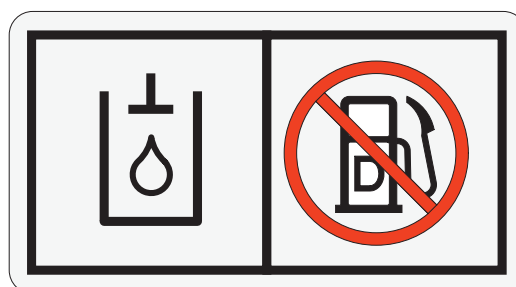

140WH90FW51

28) ULTRA LOW SULFUR DIESEL (item 44)

This warning label is positioned on the left side of fuel filler neck.

- ※ Use ultra low sulfur fuel only.
- ※ Ultra low sulfur fuel sulfur content ≤ 15 ppm
- ※ If ultra low sulfur diesel is not used, the aftertreatment diesel particulate filter can be damaged.

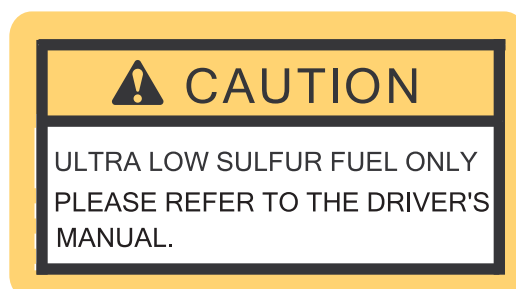

2609A0SL03

29) EMERGENCY FIRE HOLE (item 45)

This warning label is positioned inside of the engine hood inlet cover.

※ **Refer to the page 4-29.**



955TM0FW20

30) NO STEP (item 46)

This warning label is positioned on the engine hood.

⚠ **Don't step on the engine hood.**



9800FW08